



The **Sonar Guide** alerts the user to drop-offs, step-ups, and low-level obstacles in their path of travel



Sonar Guide

USER INSTRUCTIONS

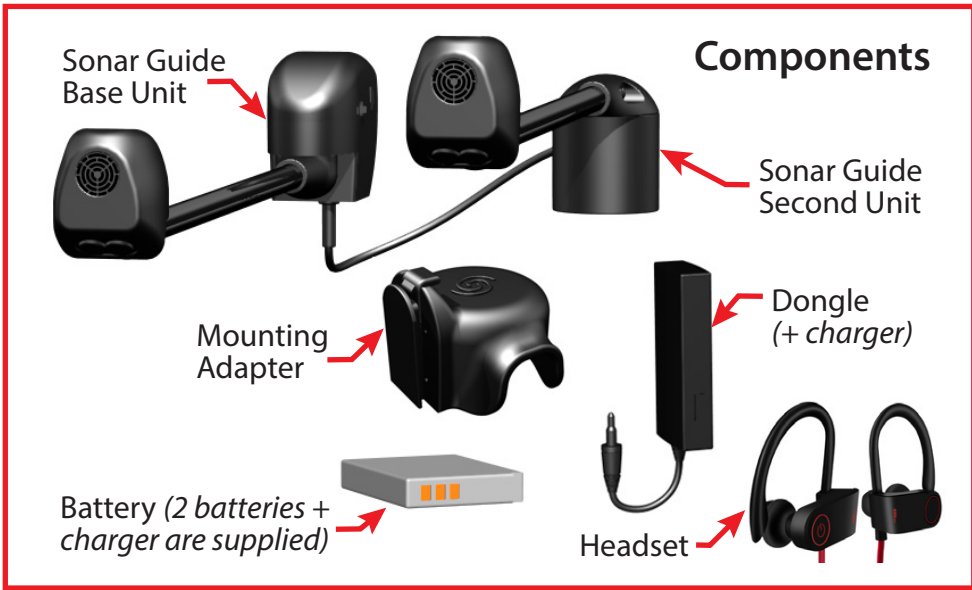

1 Install Mounting Adapter & Second Unit

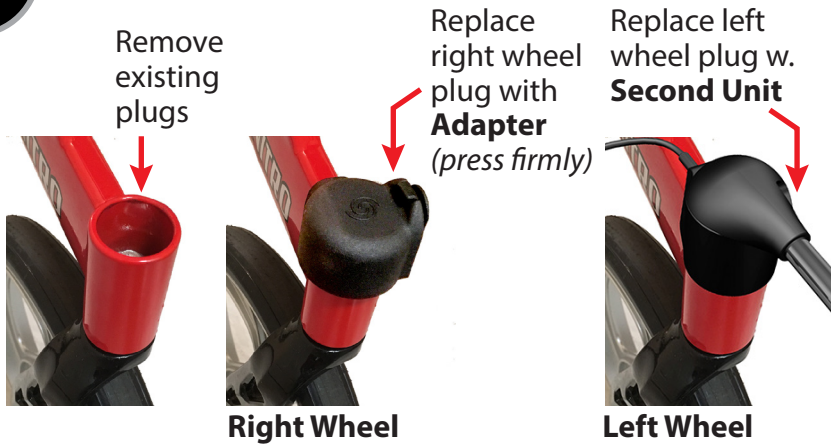

2 Install Sonar Guide Base Unit

- Slide the base unit down onto Mounting Adapter until the catch clicks. To remove push the catch away from the unit, and slide the unit upwards.



3 Insert Dongle and Battery

- The headset included in the kit is **paired** already, and shouldn't need pairing (follow manufacturer's instructions if you are using your own headset). To pair the headset to the dongle press and hold **dongle** power button until dongle light flashes **blue** and **red** (6 seconds). Release the power button. Place your **headset** within 3 feet of the dongle and **press and hold** power button until light flashes **blue** and **red** for 3 seconds. Release headset power button and wait for devices to pair (~1 min.)
- Remove Battery Cover, and insert Dongle and Battery as shown (both should be charged).

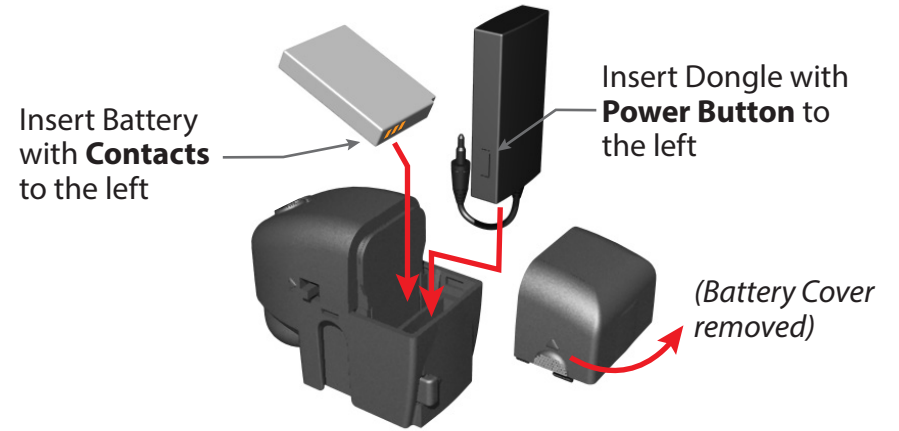

- Plug in **Dongle Plug** as shown.

Dongle stays paired as long as it is ON. To turn it either OFF, or ON press and hold **dongle button** for 3 sec.

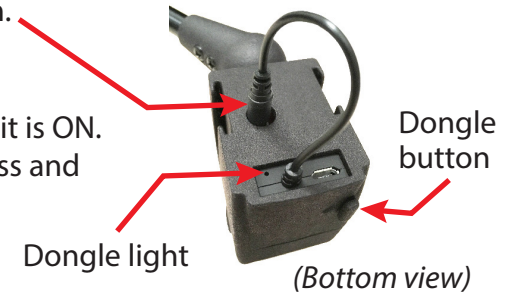

4 Calibrate

1. Place the walker on a **hard, flat surface**, and make sure there are **no obstacles** between the Sonar Guide and the floor.
2. Position each arm, and turn Power Switch **ON**. Units calibrate one after another. A **single beep**, and a **blinking yellow** ● LED indicate the beginning of calibration. When completed, you will hear **three beeps**, and the LED will go off, indicating the Sonar Guide is **ready for use**. Every time the arm position changes, re-calibrate the unit by turning it OFF, then ON again. *Make sure the surface is flat, without obstacles.*



5 Operate Sonar Guide

1) Position Sonar Guide

Sonar Guide arm needs to be positioned and extended away from the walker, and towards potential obstacles.

2) Detect Step-Ups and Dropdowns

Sonar Guide will detect changes in elevation (drop-offs and step-ups) of 3 or more inches. When a **change in elevation** is detected (drop-off or step-up), the **LED will turn blue** ● and you will hear a headset voice say one of the following: "**Dropdown Right**", "**Dropdown Left**", "**Step-Up Right**", "**Step-Up Left**", or either just "**Dropdown**", or just "**Step-Up**" if both units detect at the same time (*even if an obstacle is also detected at the same time, only the step-up is announced*).

3) Detect Obstacles

Sonar Guide detects obstacles in the user's path of travel below waist level at a distance of 3 feet from the sensor. *NOTE: obstacles beyond the width of the walker (to the right or left of the user) will not be detected.* When an **obstacle** is detected, the **LED will turn red** ● and you will hear a voice say "**Obstacle Right**", "**Obstacle Left**", or just "**Obstacle**". **To turn headphones off** press & hold **dongle** button for **3 sec**, then press & hold **headset** button for **3 sec** until "**Power off**" is heard.

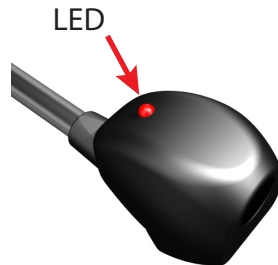

LED alerts color guide

- Solid GREEN: ● The power is **ON**
- Blinking YELLOW: ● Sonar Guide is **calibrating**
- Solid RED: ● An **obstacle** has been detected
- Solid BLUE: ● A change in **elevation** has been detected

Beep tone guide

Single tone: Sonar Guide power is **ON**

Three successive tones: Sonar Guide is **calibrating**

Package content

1. Sonar Guide (double unit)
2. Nitro Adapter
3. Dolomite Adapter
4. Dongle
5. Rechargeable batteries (2)
6. Battery charger
7. Dongle charger
8. Headset



G-TECHNOLOGY GROUP™

For more info contact:

G-Technology Group
571-249-1290, ex 1120
info@sonarglasses.com

